



Tiny footprint, huge benefit



Climate change is an issue that has gained much widespread concern in recent years. With rising temperatures and sea levels being witnessed across the world, this matter is one that is a cause for mounting alarm. The issues that accompany this problem are numerous, but it is clear that one of the main definitive cases is that this is predominantly an issue caused by the human race. Scientists have attributed the climate change largely to greenhouse gas emissions and have issued dire warnings if the emissions are not curtailed.

The UK is committed to reducing its greenhouse gas emissions by at least 34% by 2020 and 80% by 2050, relative to 1990 levels. With commercial and domestic properties accounting for close to 50% of greenhouse gas emissions, half of which is attributed to the inadequate insulation of 14 million homes, the UK Government's carbon management plan has resulted in a number of key initiatives to ensure that they are successful in achieving their goals.

The Green Deal is the Government's flagship initiative from the 2011 Energy Act and its aim is to increase the energy efficiency of UK buildings in both the public and private sector. The flexible framework will facilitate the recommendation of energy efficient property improvements, the cost of which is offset by the savings on energy bills, this is known as the 'Golden Rule'.

A further initiative which underpins the Green Deal is the Energy Company Obligation (ECO). This is designed to provide funding for the fuel poor and hard to treat properties that may require more expensive measures that may not necessarily meet the 'Golden Rule', such as external wall insulation (EWI). ECO is a legal obligation placed upon the larger energy companies to fund improvements to the properties of eligible households via grants.

It is estimated that around 35% of the overall heat lost from buildings in the UK dissipates through uninsulated external walls. EWI has been recognised as the most efficient measure of insulating properties constructed from solid walls, or those with cavities that are categorised as 'hard to treat'. It is also widely specified on new build projects where BREAM goals are key.

EWI will also assist councils and commercial businesses to achieve their carbon management goals and lower their energy consumption levels whilst greatly limiting serious decay from occurring in the fabric of their buildings. The UK Government and businesses operating in the UK face increasingly tough decisions as they tackle financial performance alongside carbon targets, global economic effects and the risks of energy scarcity and climate change.

Dryvit has a range of EWI system options that will assist in meeting even the most onerous carbon management plan. Also, as a responsible company Dryvit regularly reviews the environmental impact of the materials we use and the manufacturing processes we employ prior to delivering finished goods. Our green philosophy is summarised by the phrase "tiny footprint, huge benefit". Our environmental impact is small, and the overall benefits of Dryvit systems are huge. In summary, less cost to install and operate with and an even smaller environmental cost.



BBA issue Drysulation™ Certificate



The British Board of Agrément (BBA) has issued certification for Dryvit's Drysulation external wall insulation system (EWI). The system already held a European Technical Approval (ETA) prior to BBA review with a proven track record for Dryvit on installations across Europe. Drysulation has been introduced to the UK market with Green Deal and ECO in mind but it also compliments our comprehensive range of EWI systems for use on private, public or commercial projects.



BBA certification was deemed necessary to extend the system offer covered under the existing ETA specifically for the UK market. The system certification now includes standard grade (white) and high performance low lambda (grey) expanded polystyrene, high performance HDP 'hydrophobic' silicone based finishes, FD PMR accelerated film forming acrylic based finishes, Brick Effect finish and a wide range of Dash Aggregate finishes.

Visit our web site to view the Drysulation promotional system sheet, specification, detail drawings and other associated literature - www.dryvit.co.uk

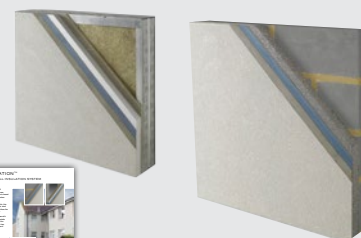

For full Drysulation system literature visit www.dryvit.co.uk

Speciality Finishes Feature



Contact us on
01462 819555
www.dryvit.co.uk





Reflectit™ - make your project shine!

A shiny reflective look is an attractive building option. For years designers have had few options with which to create this desirable appearance, other than traditional expensive materials offering little insulation value. Dryvit's Reflectit finish now makes this possible, with an array of possible textures and colours limited only by the imagination.

When Reflectit is used as the top coat on any Dryvit external wall insulation (EWI) system, the result is a lightweight, cost effective, energy efficient, engineered cladding system that will meet the owner's budget without sacrificing the desired aesthetics.

Suitable for all types of construction, Dryvit EWI with Reflectit offers numerous benefits:-



- **Reduces material requirements:** Dryvit's lightweight EWI saves on costly structural elements and associated energy and labour required to transport and install these structural components.
- **Saves construction time:** reduces transition joints between different cladding systems.
- **Energy efficiency:** Dryvit EWI and Reflectit delivers optimal energy efficiency compared to traditional equivalents.
- **Environmentally practical:** Dryvit EWI has a tiny "ecological" footprint while delivering huge benefits.



HDP™ - HyDroPhobic Finishes Like water off a Penguin's back

When drops of water hit a wall, they tend to flatten out and cling to the surface until evaporation occurs. The wet surface of some walls attracts and spreads dirt, which in turn can create an environment conducive to the growth of microbes such as mould and mildew - which are unsightly at best and potentially harmful to the surface if not removed.

Dryvit Systems has developed a revolutionary formulation that utilises both state-of-the-art silicone technology and fractal geometry that enables a wall surface to literally repel water - allowing it to dry faster and slow the accumulation of unpleasant contaminants. This hydrophobic capacity is now available in selected textured finishes as well as paint and is identified by the acronym "HDP".

Why not shed water off your building like the water of a Penguins back and use our HDP finishes on your project.

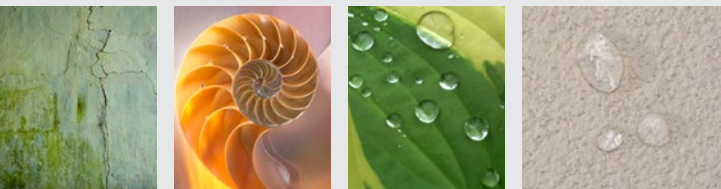

hydrophobic (*adj.*) 1. Lacking affinity for water; tending to repel and not absorb water; tending not to dissolve in or mix with or be wetted by water.

Dryvit Wood Effect - I can't believe it's not wood

Dryvit Wood Effect is a white ready to use blend of polymer modified cementitious powders, which only require the addition of water to produce a high quality finish. After application a wood grain texture is created by impressing a flexible wood pattern moulding into the render before it has set.

Once the desired grain pattern has been achieved and the render allowed to cure a Dryvit Wood Stain or solid colour coating, either Dryvit Demandit or Silstar, can be applied to facilitate the desired finish.

Timber cladding, like brick and other cladding options, is supplied as a separate component to insulation and other ancillary items and in many cases they are installed by different trades. Using Dryvit Wood Effect as a finish option over one of our external wall insulation systems can prove to be a cost effective alternative, avoiding complicated system transition details, with a single source responsibility for product.

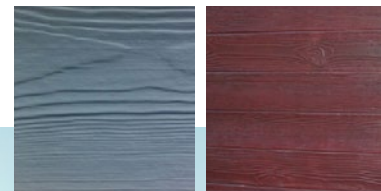

Speciality finishes are available in a wide range of colours and textures, visit www.dryvit.co.uk

Contact us on
01462 819555
ukenquiries@dryvit.com

